

Evolution README



The 1996 British National Science Fiction Convention

INTRODUCTION

So what *is* a README?

This is the **README**, the publication that tells you everything you need to know about *Evolution*. Please read it **before** asking any questions. If you have questions **after** reading it come and ask us in Ops. You'll find Ops on the third level - just follow the signs. If you lose your **README** you can buy a replacement from Registration (it'll cost you 50p).

All information in the **README** was correct when we went to press. **Any changes will be in the newsletter.**

CONTENTS

Convention Information	1
Hotel Information	4
Programme Information	4
Local Information	5
Pub Guide	6
Restaurant Guide	7
Friday Programme	9
Saturday Programme	12
Sunday Programme	15
Monday Programme	18
Video	20
Local Map	21
Hotel Maps	22

CONVENTION INFORMATION

Emergencies

Contact Ops or Hotel Reception if you have an accident or are ill. First Aid is available, and First Aiders will be identified by badges.

Registration

This will be open at the following times: **Thursday** 16:00 - 20:00, **Friday** 10:00 - 20:00, **Saturday** 10:00 - 18:00, **Sunday** 10:00 - 16:00, **Monday** 10:00 - 12:00

Day Memberships

These cost **£15.00** a day on **Friday, Saturday & Sunday**. **£10.00** on **Monday**. They're valid until 10:00 on the day after issue.

Badges

Please wear your badge at all times. We reserve the right not to replace lost badges, and to make a charge for replacement. Remember, your badge is your only proof that you are a member of the convention.

Newsletter

The Newsletter is being run by **Bridget Wilkinson**, and will be full of important information and programme changes. Well, it's more likely to contain scurrilous gossip in foreign languages, but, hey, life's never perfect. The **Newsroom** is on the landing between the **Lobby** and the **Dealers**. Please feel free to call in with offers of assistance, scurrilous gossip, important news and the like.

We're All Volunteers!

This convention is run entirely by volunteers, doing it during their holidays. Please remember this in your dealings with convention staff - we're all here to have a good time together. Oh, and remember to be nice to the hotel staff too, they **have** to work over Easter; so please don't make life harder for them than it has to be.

So, Why Don't You Join Up, And Join In!

Every convention needs gophers. "What are gophers?" I hear you cry. These are the people who volunteer to run around doing things at the convention, going for this and going for that. They're very important to the success or failure of a convention. No experience is necessary and it's a good way to meet people and find your way around. You never know, you could end being one of the lucky few running an Eastercon...

First Aid Volunteers

Will Volunteer First Aiders please make themselves known to Ops as soon after arrival as possible, where they can collect a First Aid Badge.

Hotel Problems

If you can't resolve any problems with the hotel, please contact Ops, who will contact our Hotel liaison team for you.

It'll be helpful if you don't take any glasses into the pool area.

No Glass In The Pool Area!

Don't take any glass into the pool area!

"Why not?" you may ask (we like these rhetorical questions!).

Quite simple, really: if broken glass gets into the pool, the hotel will have to drain it. They can't do this over Easter, and they can't let people use it with broken glass in it. The swimming pool would be shut. We'd get a big bill. The perpetrator would be very unpopular, but that's all right because they wouldn't be at the convention anymore. **We're not joking.** There will be plastic glasses available, put your drinks in those. Encourage others to do so, report any glasses, attended or unattended, to hotel or convention staff, and if you forget, don't hassle those who remind you. So, remember, no glass in the pool area.

Weapons Policy

No real weapons may be carried under any circumstance. No realistic replica weapons except as part of a Masquerade costume. **No projectile weapons of any kind.** The Chief Steward, **Gary Stratmann**, has the final decision on what constitutes a weapon, and he, his deputies or the committee may confiscate anything, at any time, for any reason.

Awards

There will be ballot boxes at Registration for the **BSFA Awards** and for the **Doc Weir Award**.

Dealers Room

The **Dealers Room** is in the **Royal Annex** on the **Third Level** This is open as follows **Friday 14:00 - 18:00, Saturday 10:00 - 18:00, Sunday 10:00 - 18:00, Monday 10:00 - 14:00**. You cannot take food or drink into the Dealers Room unless you are a dealer. There will be **signing sessions** in the **Royal Annex** each day at **17:00**, check the newsletter for names of authors. There will be a **comics signing** on **Saturday** at **12:00**. If you're an author and you'd like to take part in a signing session, please let us know.

Art Show

The Art Show is in the **Ascot Room** at the back of the hotel on the **Ground Level** and will be open: **Saturday 10:00 - 18:00, Sunday 10:00 - 14:00**. The Art Show shuts two hours before the **Art Auction** at **16:00** on **Sunday**. The Art Auction is also being held in the **Ascot Room**. The Art Show will not reopen after that time

Con Desks

Some of these will be in the **Royal Annex**, some in the **County Annex**. Please see **Tim Illingworth** in **Ops** if you want to set up a con desk. We cannot secure con desks.

Book Auction

If you have books to be auctioned, please give them to **Ops**, clearly labelled with the name of the seller and where the proceeds should go (the seller, charity, elsewhere). The con will take a 10% commission for non-charity items.

Profits

Evolution is a non-profit making organisation. Any profits remaining after the convention settles its accounts will be distributed amongst a number of fannish and/or charitable good causes, one of which will be **Intermediate Technology**. Intermediate Technology exists to raise funds for appropriate technology in developing countries

Smoking Policy

We strongly discourage smoking in the programme areas. If you must smoke there will be a smoking section in the **County Room**. **Only Programme participants and Tech crew** may smoke in the **Windsor** and **Richmond** rooms. **Only dealers** may smoke in the **Dealers Room**. There is no smoking in the **Art Show**. In workshop and syndicate rooms, filking sessions and costuming programme, **smoking is at the discretion of the organiser**. As it's also a food service area, the **Connaught & Belvedere** is a **non-smoking bar**, the **Polo** will be a **smoking bar**.

Posters And Signs

We don't want to damage the fabric of the hotel. Posters and signs may be fixed to **Glass, Wood** and **Metal** only using **BluTac**, no drawing pins, **but never ever to wallpaper!** Please don't obscure the hotel or the convention's signage - the hotel layout is quite complicated and we're worried about losing people in these endless corridors if the signs are obscured. And don't stick things to the wallpaper.

HOTEL INFORMATION

Hotel Layout

The layout of the hotel is quite complicated, but we've done our best to signpost it for you. In the **Lobby**, where **Registration** is, you are on the **Ground Level**. **Reception** is on your left as you're facing in from the door. The stairs in front of you lead up, past the **Newsroom** on the **Second Level** to the **Programme Rooms** on the **Third Level**. The **Pool Area** is the place that you don't take glasses into (have we said this enough, yet?)

Pool Area And Health Club

This is free for residents of the hotel. So if you've got a room, splash about to your heart's content. Oh yes, did we mention that you don't take glasses into the pool area?

Hotel Food And Drink

Convention food & drink will be served in the **Connaught & Belvedere** room on the **Third Level**. Food will be served between **11:00** and **22:00**. The **convention bar** will remain open until at least **02:00**, and later if there's demand. There are **two other bars** in the hotel, the **Polo Bar** with those interesting seats and **The Drawing Room**. The **Brasserie** is more expensive than the **Connaught & Belvedere**, and **Henley's Restaurant** is more expensive still. Both restaurants will do an à la carte menu as well. The **Brasserie** is open from **11:30** to **23:30**, **Henley's Restaurant** is open from **18:30** to **21:30** for dinner. **Breakfast** will be served between **7:00** and **11:00**. The hotel will check breakfasts against room keys, but you may buy breakfast if you are not staying in the hotel.

Corkage

Corkage rates are available; if you wish to bring food and drink in from outside please see Ops to arrange this. **WARNING:** Remember hotels make money by selling accommodation, food and drink. Please do not attempt to bypass this procedure or enter into competition with them. The convention will not support you in the event that you get caught.

Room Payment

When you check in the hotel will ask for a credit card impression or cash in advance. Remember that you can provide credit card details, but still pay in cash.

PROGRAMME INFORMATION

Evolutionary Themes

Our main theme is how things evolve and change, with exploration of the past, the present and the future. We'll be spending time looking at British SF, with our "**A Very British Genre**" series - this is based on the book written by one of our guests, Paul Kincaid, and published last year by the British Science Fiction Association. In five linked panels we'll be exploring the history of British SF from its earliest days.

Workshops

There will be an extensive workshop programme of massage, belly dancing, Victorian gadgets, jewellery, KenJo games, and basic tech. These are limited in numbers so please sign up as soon as possible in Ops. If you turn up at the Workshop without having signed up in advance and there are no places, tough. If you do sign up, and later change your mind, please let Ops know this as well.

Costuming

The costuming programme stream takes place on the **Fourth Level** in the **Wentworth** room. As well as what's shown in the programme, there will also be videos of earlier masquerades,

sewing circles and generally busy fun activities. This is open to everyone with an interest in costuming or masquerades, and they're always interested in new blood (there are the sacrifices to take care of, after all...).

Masquerade

If you want to take part in the Masquerade, you must tell Ops or the Masquerade organisers in the Wentworth room as soon as possible. Make sure to discuss any special tech or audio requirements with the Masquerade organisers **in advance**. The masquerade organisers are Alice Lawson and Krystyna Oborn.

Writer's Surgery

The numbers for this were limited, and all places are now full. If you have a place, you will find a note in your pack giving details.

LOCAL INFORMATION

Local Shops (And Not So Local)

There is a small shop in the hotel for emergency supplies of chocolate, souvenirs and the like. Near to the hotel, there are three reasonably nearby shopping centres. Firstly, you can walk to the village of **Harlington** in a few minutes. It has a selection of small shops, including newsagents, a couple of takeaways, a **pharmacy** and the like. Further away, but accessible by bus or car (about five minutes away) is **Hayes** itself. This is a typical, but small, British high street, with newsagents, small general stores and so on. The main supermarket is on the ring road around the town. Finally there's **Heathrow Airport** itself. We don't recommend this, as Heathrow can be quite busy and expensive, but it is open early and late but not 24 hours. Finally, if you were born to shop, trains run from **Hayes & Harlington Station** to **Windsor, Reading and Central London** (for Oxford St and Charing Cross Rd). Windsor's a bit touristy, Reading's got all the usual big stores, Oxford St needs no introduction and Charing Cross Rd is a bibliophile's mecca.

Pharmacy

The pharmacy in **Harlington** will be open on **Saturday**. The pharmacy in **Heathrow Terminal 2** will be open between **07:00** and **21:00** every day.

Cash Machines

The nearest cash machines that we know of are in **Hayes**.

Churches

The nearest churches are; RC, Immaculate Heart of Mary, Botwell Lane, Hayes 0181 573 2065; CoE, St Anselm, 101 Nield Rd, Hayes 0181 573 0958.

Days Out

An interesting, if expensive, day out is a trip to the new **Legoland** at Windsor Safari Park, which opened last weekend. It's £15 for adults, £12 for children.

THANKS

I'd like to offer special thanks for assistance with programme and this **README** to:

Mike Scott for assistance with the **programme**, **Tony Cullen** for the **Pub Guide**, **Chris O'Shea** for the **Restaurant Guide**, **Maureen Kincaid Speller** and **Paul Kincaid** for their advice, **Simon Bisson** for editing the **README**, **Krystyna Oborn** for assembling the **Costume Programme** and all those hundreds of people who've offered advice, help and most of all, **participation**. And of course, **SMS** for the **cover art**.

Pat McMurray

Guide to the Pubs around The Radisson Edwardian Hotel.

I have limited the selection of pubs to those within 1 mile (as the crow flies) from the hotel. The beers named are the hand pumped beers available, and the 'Star Rating', from 1 to 5 is a personal view of the standard of the beer. All views expressed in this guide are those of the reviewer and will probably not be those of a lot of other drinkers...

Tony Cullen

The Crown, Sipson Road (A408), Sipson

- Open 11-11 (Mon-Sat) 12-3, 7-10:30 (Sun). Food 12-2 (Mon-Sat) bar snacks
- **Chadwick's Finest; Courage Best; (***)**
- Smallish village local, recently refurbished into a pleasant no frills pub.

The Office, Bath Road (A4)

- Open 11-11 (Mon-Sat) 12-10:30 (Sun). Food 12-9:30 (Mon-Sat) 1-4 (Sun)
- **Courage Best; Marston's Pedigree; (****)**
- Friendly, but noisy pub opposite the Trust House hotel. Beware the Friday night karaoke.

The Pheasant, West End Lane, Harlington

- Open 11-11 (Mon-Sat) 12-10:30 (Sun) (extensions till 12:00 midnight Easter Sat and Mon). Food all day, plus restaurant at rear open in the evening.
- **Chadwick's Finest; Courage Best; (***)**
- Busy yet friendly food oriented pub. The closest pub to the hotel, has its own charity well and a very strangely shaped restaurant at the back.

The Red Lion, High Street (A437), Harlington.

- Open 11-3, 5-11 (10:30 Sun). Food 12-2, 5:30-8 (Mon-Fri)
- **John Smith's Bitter** (occasionally); (**)
- Small basic local pub. Large screen TV for Football matches.

The Three Magpies, Bath Road (A4)

- Open 11-11 (Mon-Sat) 12-10:30 (Sun); food all day (8:00am breakfast)
- **Theakston's XB, Best Bitter; John Smith's Bitter; Courage Best; (****)**
- Comfortably refurbished, food oriented pub on the A4. Popular with taxi drivers.

The Wheatsheaf, High Street (A437), Harlington

- Open 11-3, 5-11 (10:30 Sun). Food 12-2, 5-8 (Mon-Sat)
- **Courage Best; Webster's Yorkshire Bitter; (***)**
- Friendly village local, don't be put off by its appearance.

The White Hart, High Street (A437), Harlington

- Open 11-11 (10:30 Sun). Food 11-9:30 (Mon-Sat) 12-3, 5-9 (Sun)
- **Fullers Cheswick Bitter, London Pride, ESB, London Porter; (*****)**
- Lively, sometimes noisy, very popular pub. Definitely worth the walk.

The White Hart, Bath Road (A4)

- Open 11-11 (10:30 Sun). Food all day
- **Courage Best; Theakston's XB, Best Bitter; (***)**
- Large roadside pub with "Conservatory overlooking Flight Path".

The William IV, Harmondsworth Lane, (off A408), Sipson

- Open 11-3 5-11 (Mon-Fri) 11-11 (Sat) 12-10:30 (Sun) Food 12-2, 5-8
- **Bass; Webster's Green Label; Courage Best; (*****)**
- Very pleasant 16th century pub just off the main road. Watch your head on the door to the car park

A Brief History of Food

being an incomplete guide to food and restaurants near the Radisson...

Since this is an airport hotel on the main A4, the options for food within reasonable distance of the hotel break down into the following:

The Radisson Edwardian. Every time I've eaten there it has either been a buffet put on by a computer company, or a "banquet" put on at the end of a company meeting so I can't tell you what the normal restaurant food is like. On the other hand it *is* local!

A Pub. There are a number of pubs, some in walking distance, and many more a short taxi or car ride away. A list of the ones recommended or avoided by the Radisson's concierge are given below.

Fast Food. Depending on how far you like to walk, there are only a few places within walking distance of the hotel. Those that I could find are listed below; if you find others please let the newsletter know!

A Restaurant (other than one in a hotel or pub). As far as I could determine by driving around and around the area, there are none within easy walking distance of the hotel. A list of recommended places slightly further from the hotel is given below.

Pubs

The Five Bells Harmondsworth Village This one was particularly recommended by one of the porters at the Radisson, especially for the Irish bitter. Same directions as for the King William below, but once you reach the King William turn left and go down a country lane and it is on the first road on the right.

The Ostrich Colnbrook 0753 682628. This is described as a quintessential old English pub and mutters of "Dick Turpin" were also to be heard. Recommended.

The Pheasant West End Lane 0181 759 9685. The pub has good beer and good pub food and there's a restaurant attached which has had several good reviews. Walking distance from the hotel. Go out of the front of the hotel, turn left onto the main road, take the first turn on the left (which has a signpost for The Pheasant), and it's about 5-10 mins walk. I've eaten at the pub (not the restaurant) several times and the food was always good (for pub food).

The Plough Sipson Road 0181 759 1938. Out of the hotel, turn right onto Bath Road and right at the lights towards Sipson. At first you will think you're on the wrong road since it all seems either residential or empty land but then you'll pass the Crown pub on the right and the Plough is a bit further down on the right. It is probably not walkable. The lunch there is particularly recommended.

The Red Lion High St., Harlington 0181 759 7514. Out of the hotel, turn left onto Bath Road and left at the lights. About ¼ mile down you'll find the Red Lion on the right (if I remember correctly). The advice I was given is that if you've got that far the White Hart is only a short distance further on the left and is well worth the extra walk. ½ mile from front of hotel.

The Three Magpies Bath Road 0181 759 1071. almost directly opposite the hotel (across the A4) but not recommended

The White Hart High St., Harlington 0181 759 9608. Same directions as the Red Lion but more highly recommended. ½ mile from front of hotel.

King William IV Sipson Road 0181 759 9874. Out of the hotel, turn right onto Bath Road and right at the lights towards Sipson. At first you will think you're on the wrong road since it all seems either residential or empty land but then you'll pass the Crown pub on the right and the Plough is just a little bit further down on the left, be careful or you'll drive past it since the "front" faces down the road away from the direction that you're driving. It is walkable but it is a fair walk (more than 10 minutes). Very highly recommended.

Restaurants

Indian Hayes Tandoori Station Road, Hayes 0181 573 4949. This is described as the best tandoori around! About 2½ miles from the hotel, so not a walk unless you *really* want to build up an appetite. Of course, once you're in Hayes there are a number of other restaurants around but I'll leave them to you to track down and review for the newsletter.

Italian Basically there aren't any recommended ones near the hotel so you have the choice of the **Terraza** in Ashford (01784 244887) Ashford is about 8 miles from the hotel (so definitely not walking distance!) but again once you're in Ashford, there are a number of other restaurants (including a particularly good chip shop called Jack's), or **Antico** on Eton High Street (0173 863977). I don't have any other details about this except it is on the list from the Radisson concierge. Eton seems to be a good place to go if you want a range of good restaurants so my advice is to get a taxi there and wander around! You might also try Windsor (not the castle but the local restaurants) if you're driving around the area.

Chinese Pangs Cottage Yeading 0181 845 2776 **Go Sing** West Drayton 01895 44174 **Hee's** A4 (heading towards London) I can highly recommend Hee's, a very good Chinese restaurant on the A4 heading in to London, but it is a good way in (10-15 minutes drive) and not cheap (though not as expensive as some of the Chinese in Central London!)

Fast Food

I'll just mention a couple near the hotel, see notes on the area below for where else to try.

McDonalds Right next to the hotel is a 24 hour drive-through McDonalds, so I'll be fed for the convention! They seem to switch over to the breakfast menu about 6am and back to regular "food" around 10:30-11:00. One word of warning: a colleague ordered a fish sandwich there about 4am one morning and it was a bit dried out, so check your food and demand a fresh one if necessary.

Harlington Tandoori High St., Harlington 0181 476 3300. Indian/Nepalese restaurant and food store (several shop fronts adjoining), just about opposite the Red Lion (so follow directions as above). The food store has a sign saying it's open until 9pm but when I went by there at 10:15 pm it still looked open.

Fish & Chips/Kebabs High St., Harlington A couple of doors down from the Tandoori, and opposite the Red Lion. I had a saveloy and chips and I got a big bag of chips for 75p. I think I probably went at a bad time (just before closing) but it tasted like some of the chips were freshly cooked and some had been sitting drying out for a while. Nonetheless cheap, filling and the freshly cooked chips were very nice! Open until 11pm but shut on Sundays.

Other restaurants/fast food etc.

Heathrow Airport has a large number of food places that range from quite high quality restaurants through to Burger King and cafeteria-style food. Terminal 1 is a short mortar-bomb lob from the hotel.

The general area near the hotel (say, within 10 miles) consists of a vast number of small towns linked by good roads and each small town is likely to have Chinese, Indian and Fish & Chip shops. There are also quite a lot of pizza delivery places and such. The A4 runs past the hotel and if you head out towards the M25 there is a wine bar/restaurant on the right which I didn't have time to check out. If you take the A4 in towards London you'll pass a lot of hotels, a good howling alley (with a McDonalds in it, I believe), and then you are on the long run into London with various restaurants and take-aways every couple of miles. (There is also a big guitar shop on the right when you're near Hounslow for you filkers who need new strings...). I've just been told there is a good Mexican restaurant in Staines, and since there are a large number of other restaurants and shops there, it might be worthwhile checking out.

Chris O'Shea

Friday

	County	Windsor	Richmond	Aintree (Workshop)	Kempton (Workshop)	Costume	Other
1300	SF & Drama						
1400	Opening Ceremony						
1500	The Transformation of Horror	So this is your First Convention?		Interstellar Communications			
1600	A Very British Genre 1	I Lived with Ro-Jaws			Martial Arts		
1700	Balkanising Britain	The Future of Publishing & Booksellers				Introduction to Chaos Costuming	Book Signings: Royal Annex
1800	Redesigning the Human Body for Fun and Fornication						
1900	Film:	Changing of the Guard	SF Journalism		Face & Neck Massage		
2000		The Long Term Future of Life in the Universe					
2100	GOH: Maureen Kincaid Speller and Paul Kincaid						
2200	Fandom of the Opera		Beerhunters				
2300			The Circle Widens — the Development of Filk				

Friday

- 1300** **County: SF & Drama** Oddly enough, for all its obvious dramatic potential, SF is rarely presented on the stage. What sort of SF drama does work best, and why? Kathy Taylor, Michael Cule, Geoff Ryman.
- 1400** **County: Opening Ceremony** The Big Opening Ceremony — meet the guests and the committee.
- 1500** **County: The Transformation of Horror** The horror novel has evolved through the years. What has changed in the genre and why? Tanya Brown, John Brosnan, Freda Warrington, Mike Jeffries, Graham Joyce.
- Windsor: So this is your first convention?** We'll give some advice on how to have fun, make sure you don't miss the interesting bits, and go home with good memories. Pop in even if you've been to Intersection! Jilly Reed, A³, Priscilla Olson, Ian Sorenson.
- Aintree: Interstellar Communications — A Workshop** Would a Voyager style message work in practice? Come along and find out when your race sends its message to another system. Roundtable & Workshop with Benedict Walmisley. First of three sessions.
- 1600** **County: A Very British Genre, Part 1 — The Monster Wakes** This is the first of five panels on the history of British Science Fiction. This series is based on a book written by Paul Kincaid (one of our guests) and published by the British Science Fiction Association last year. Each panel stands alone, but together they'll give an overview of the subject. Paul Kincaid, Maureen Kincaid Speller, Andrew Butler.
- Windsor: I Lived with Ro-Jaws** Two artists discuss their involvement with Britain's greatest modern SF comic — 2000AD. Bryan Talbot, SMS.

Kempton: Martial Arts Workshop A one hour session with Gary & Linda Stratmann on Fighting Arts and their applications.

County: Balkanising Britain Why is the idea of a fractured Britain so fascinating to British authors? And why do authors today see this as the result of social pressures rather than natural disasters as in earlier SF (for example John Wyndham & John Christopher). John Dallman (Moderator), Peter F Hamilton, Michael Marshall Smith, Ken MacLeod.

Windsor: Future of Publishing & Booksellers The demise of the Net Book Agreement and the rise of CD-ROMs have done nothing to make life as a book publisher or seller any easier.

Royal Annex: Signing Session Look out for notices telling you who's going to be on each signing session.

County: Redesigning the Human Body for Fun & Fornication A reprise of a very popular talk by Jack Cohen, first given at Intersection, last year's WorldCon in Glasgow

County: Film To Be Announced

Richmond: SF Journalism What's it like working as an SF Journalist? Simo, Jane Killick, Peter T Garratt.

Windsor: Changing of the Guard SF has always had icons, but why do some go on forever, while others have a finite lifespan. Roger Robinson, David Pringle, Priscilla Olson, Sam Lundwall, Chris Amies.

Kempton: Face & Neck Massage This workshop teaches specific anti-stress, anti-headache techniques, using hands only, no oils or gadgets. Bobby McLaughlin.

Windsor: The Long Term Future of Life in the Universe Will life and intelligence survive the death of the solar system? The heat-death of the universe? The decay of protons? What real prospects are there for intelligence as the universe grows old? A presentation by space scientist, Dave Clements.

1700

1800

1900

2000

1800

County: Maureen Kincaid Speller & Paul Kincaid, Our Fan Guests Of Honour's Desert Island Books With a friend's help, Paul & Maureen discuss those books that have played an important role in their lives — the Desert Island Books.

2200

County: Fandom Of The Opera A conventional Rock Opera. At last, after 9 years in hiding, Ian Sorensen once again inflicts brain damage on your ears. A collection of his greatest hit.

Richmond: Beerhunters Real Ale Fans. Beer has a certain interest among UK SF fans. The knowledgeable discuss their favourite beers, their favourite conventions, and the relationship between the two. Mike Cheater, Alison Scott, Chris Cooper.

2300

Richmond: The Circle Widens — The Development of Filk The Evolution of a subset of fandom. How filking's gone from basements after midnight to a regular series of convention.s

Saturday

	County	Windsor	Richmond	Aintree (Workshop)	Kempton (Workshop)	Costume	Royal Annex
1000	Tech Workshop 1	Tim'll Fix It	Book Auction		Bringing a Fantasy Kingdom into the 21 st Century	Chaos Costuming - or 100 things to do with a bin liner! (1030)	
1100	A Very British Genre 2	Rocket Science in the Real World					
1200	Living through the Singularity	BSFA AGM	Constructions of Morality in Fantasy Gaming	Victorian Gadgets		Ice Demon	Comic Signings: Royal Annex
1300	Babylon 5 — Comes the Expositor	FoF AGM	The Next European Worldcon			What I did on my holidays	
1400	GOH: Bryan Talbot						
1500							
1600	A Very British Genre 3	Intuition Tea Party	Unseen University Challenge	Interstellar Communications 2	Belly Dancing		
1700	BoSh Remembered	Science & SF — Do they Mix	Timebinding		Shrink Plastic Jewellery	What's on the horizon	Book Signings: Royal Annex
1800	GOH: Vernor Vinge						
1900	Film: "Outbreak"	Echoes Of War	Fandom as Gynocracy				
2000		Tall Technical Tales	Intuition		Clone of Stomp		
2100	Minneapolis in '73 Bid Party		Yorkshire Water Ate My Corn Circles				
2200	Tony Morton and Band (2230)		Late Night Slash				

Saturday

1000

County: Tech Workshop One Claire Goodall presents an introduction to Tech — lights, explosions, sound.

Kempton: Bringing a Fantasy Kingdom into the 21st Century Ken & Jo Walton present "Florin has been freed from the Communist Yoke, and the rightful king has been invited back. Can you, his advisors get Florin on friendly terms with neighbouring Guilder, Ruritania and Orsinia and help him bring the country into the twenty —first century?" This is the first of three parts.

Richmond: Book Auction A great opportunity to get rid of your old tat and buy that book you've always wanted that some moron has put into the auction.

Windsor: Tim'll Fix It Tell us what's going wrong. This is your opportunity to tell us if you think something's going wrong — and we'll do our best to sort it out for you. Our services manager will be on hand.

1100

County A Very British Genre, Part 2 — Glimpsing the Future This is the second of five panels on the history of British Science Fiction. This series is based on a book written by Paul Kincaid (one of our guests) and published by the British Science Fiction Association last year. Each panel stands alone, but together they'll give an overview of the subject.. Andrew Butler, Peter Wright, L J Hurst.

Windsor: Rocket Science in the Real World What's it like working as a Rocket Scientist in the Real World — living this stuff? Simon Bradshaw, Janet C Johnston, Dave Clements.

1200

County: Living through the Singularity What will it be like? Vernor Vinge, Simon Bisson, Charlie Stross.

Richmond: Constructions of Morality in Fantasy Gaming An exploration of the interface between principle (be it personal or consensus) and imagination. Kari, Rhodri James, Mike Cule, Phil Nanson.

Windsor: BSFA AGM This is the Annual General Meeting of the British Science Fiction Association, open to all members of the convention, though only BSFA members may vote.

Aintree: Victorian Gadgets Workshop The Victorians were renowned for their countless designs of "unusual" gadgets, most of which never left the drawing board. The workshop's aim is to design gadgets that will make any Victorian feel at home.

Royal Annex: Comics Signing With Titan Comics artists/authors Peter Milligan, Dave Gibbons, Steve Dillon.

County: Babylon 5 — Comes the Expositor A close examination of a Babylon 5 episode — Guess which one.

1300

Richmond: Next European Worldcon This is the first of a set of three panels discussing the future of large-scale European conrunning. Do we want to run another European Worldcon and if so, when? Fiona Anderson, Jurgen Marzi, Ben Yalow, Martin Easterbrook.

Windsor: FoF AGM The Friends of Foundation (Registered Charity) are the administrators of the Liverpool University based Science Fiction Research Library and the academic journal "Foundation". All are welcome at their AGM.

County: Bryan Talbot, Our Artist Guest of Honour An illustrated talk about interpreting comics, by our artist Guest of Honour.

1400

County: A Very British Genre, Part 3 — The Other Side of the Dream This is the third of five panels on the history of British Science Fiction. This series is based on a book written by Paul Kincaid (one of our guests) and published by the British Science Fiction Association last year. Each panel stands alone, but together they'll give an overview of the subject. Paul Kincaid, Roz Kaveney, Peter Wright.

1600

Richmond: Unseen University Challenge Presented by DiscWorldCon. Your starter for 10. Yes, the Discworld™ equivalent of this popular game show has reached our shores to be seen for the first time ever at Evolution in preparation for it's world wide launch at The Discworld Convention in June. See two teams of contestants slog it out in mortal brain busting combat. Be there or be a rectangular pointy thingy.

Windsor: Intuition Tea Party Come and have a cup of tea with Intuition, who are bidding to run the 1998 Eastercon.

Kempton: Bellydancing Workshop Gail Courtney presents her ever-popular bellydancing workshop.

Aintree: Interstellar Communications Part 2

1700

County: BoSh Remembered.

Richmond: Timebinding Our current fannish culture owes a great deal to our past, and is strongly influenced by our hopes and fears of the future — it's Timebound. Rob Hansen, Pam Wells, Ben Yalow.

Windsor: Science & SF — Do they Mix? What would SF be like without science, and science be like without SF? Mark Olson, Mary Gentle, Stephen Baxter, Colin Greenland, Janet C Johnston.

Kempton: Shrink Plastic Jewellery Workshop Elise Mann presents a workshop on making Shrink Plastic jewellery. Materials will be provided.

Royal Annex: Signing Session

1800

County: Vernor Vinge Our US Guest of Honor. Vernor Vinge.

1900

County: Film — "Outbreak" Dustin Hoffman & Freeman Morgan star in this film about a lethal virus infecting a small California town, and a race against time to find the key to stopping it before it spreads or the government takes drastic action.

Richmond: Fandom as Gynocracy An Interesting Theory Every now and again, there appears a theory which may appear a little odd but is very interesting. This is one of those. Caroline Mullan and Greg Pickersgill.

Windsor: Echoes of War Militaristic SF Three fans of militaristic SF discuss its appeal. John Harold, Nigel Furlong, Claudia Kern.

Richmond: Intuition Presented by Intuition, a bid for the 1998 Eastercon. An interesting and exciting surprise item.

2000

Windsor: Tall Technical Tales There are some very odd things that go on in labs late at night. Survivors confess... Simon Bradshaw, Dermot Dobson, Jack Cohen, Mike Birchall.

Kempton: Clone of Stomp — Noise Workshop A percussion improvisation, audience participation most desirable, please bring hand drums, click sticks, rattles, borrowed saucepan lids, whatever. Bobby McLaughlin.

County: Minneapolis in '73 Bid Party Jim Young on the guitar AND Glam Rock, what more could you want? Bring your drinks with you.

2100

Richmond: Yorkshire Water Ate my Corn Circles Presented by Reconvene, A bid for the 1999 Eastercon. A Panel of occasional paranoids has been commissioned to expose the conspiracies which account for some of the everyday irritations of life. Peter Wareham chairs, with John Dallman, Smitty, and Alex Stewart.

Richmond: Late Night Slash Respectability? Slash fiction seems to be on the verge of gaining respectability. Is this a good thing for slash? Alison Scott, Moira Shearman, Sue Mason.

2200

Tony Morton and His Band. A live and very musical band, to play the music you want to hear. Tony and his band are fans, but rockers, not filkers.

2230

Sunday

	County	Windsor	Richmond	Aintree (Workshop)	Kempton (Workshop)	Costume	Other
1000	Masquerade Rehearsal	EuSFfC A European NaSFfC	Tech Workshop 2	APA Workshop			
1100	Bid Session					Gaffer Tape Corset Patterns	
1200							
1300	A Very British Genre 4	Video Killed The Radio Star	Delany's Children AGM		Fantasy Kingdom 2	Drafting with Calico	
1400	GOH: Jack Cohen						
1500	Moose TV — A Fire upon the Moose	The Year In SF — A Review	Chocolate is not the Only Fruit	Interstellar Communications 3			Art Auction Setup: Ascot
1600		TAFF Panel — Is That It?	The Evolution of SF — from Pulp to Academe			Historic drawers (and other things that go on under ladies' skirts) (1630)	Art Auction: Ascot
1700	Elves in Spacesuits	Illustrated Anime	Generic Engineering		Bellydancing Workshop		Book Signing: Royal Annex
1800	GOH: Colin Greenland						
1900	Masquerade Setup	The Evolution of Gay SF	Not a University Challenge				
2000	Masquerade						
2100							
2200	Zagreb in '99 Party	Captain Luddite vs. Dr Eugene X.	Fan Fund Auction				
2300							

Sunday

1000

County: Masquerade Rehearsal

Richmond: Tech Workshop Two Claire Goodall presents an introduction to Tech — lights, explosions, sound. This time, sound.

Windsor: EuSFic A European NaSFic NaSFic is the convention held in North America only in those years when the Worldcon is outside North America. Is there a case for a European Equivalent — the EuSFic? This is the second of a set of three panels discussing the future of large —scale European conrunning. Ben Yalow, Tim Illingworth Kees van Toorn, Mark Olson, Peter Weston.

Aintree: APA Workshop Maureen Kincaid Speller.

1100

County: Bid Session This is your opportunity to vote for those fools fans who'll be running the 1998 Eastercon.

1300

County: A Very British Genre, Part 4 — After the Deluge This is the fourth of five panels on the history of British Science Fiction. This series is based on a book written by Paul Kincaid (one of our guests) and published by the British Science Fiction Association last year. Each panel stands alone, but together they'll give an overview of the subject. Paul Kincaid, Colin Greenland, Steve Jeffrey.

Windsor: Video Killed the Radio Star A Casualty of the Evolution of Modern Mass Media — Radio SF: A talk by Andrew Adams.

Richmond: Delany's Children AGM Delany's Children are an organisation for Gay & Lesbian SF fans, and their friends.

Kempton: Fantasy Kingdom Part 2

1400

County: Our Science Guest of Honour — Jack Cohen A Life In Science (And on the Edge...).

1500

County: Moose TV — A Fire Upon the Moose An assortment of items for your delectation and pleasure. If you

have a party piece that you'd like to display leave a message for Steven Cain, the organiser, in the Green Room.

Richmond: Chocolate is not the Only Fruit Fans who like food, and not just chocolate. Fran Dowd, Tara Dowling —Hussey, Brian Ameringen.

Windsor: The Year in SF — A Review What was your year like? An author, a fan, an artist, a publisher and a bookseller discuss their years. Paul Kincaid, David Hardy, Pam Wells, David G Hartwell, Maggie Furey.

Aintree: Interstellar Communications Part 3

Ascot: Art Auction Setup

Ascot: Art Auction The Art show is now closed, and much of the artwork you've been admiring all weekend is up for auction now.

1600

Richmond: Evolution of SF — Pulp to Academe SF has gone from the purple prose of pulp to the respectable ivory tower of academe. What happened? Peter Wright, Maureen Kincaid Speller, Andrew Butler.

Windsor: TAFF Panel — Is that it? What's going to happen to TAFF? Greg Pickersgill, Peter Weston, Abigail Frost, Ian Sorensen.

County: Elves in Spacesuits Far Future SF Any sufficiently advanced technology is indistinguishable from Magic... John Richards (Moderator), Vernor Vinge, Stephen Baxter, Peter F Hamilton.

1700

Windsor: Illustrated Anime Helen McCarthy talks about Anime, with Video clips.

Richmond: Generic Engineering Mainstream & SF We think we know what SF has done to the mainstream, but what has the mainstream done to SF? Paul Kincaid, Ken MacLeod, Chris Priest, Molly Brown, Bryan Talbot.

Kempton: Bellydancing Workshop Gail Courtney presents her ever popular Bellydance workshop for the second (and possibly last) time until next time.

Royal Annex: Signing Session

1800 County: Colin Greenland — **In conversation with our Guest of Honour** Colin reads from his work and is interviewed about his life and works.

1900 County: **Masquerade Setup**

Richmond: Not A University Challenge Mike Cule challenges two teams of elite skiffy trivia experts to display their erudition in a quiz that steals from every TV quiz show he can think of. Except one....

Windsor: The Evolution of Gay SF Delany's Children present: A discussion of the emergence of gay writers and writing in SF. Helen Steele, Roz Kaveney, Jack Davies.

2000 County: **Masquerade** Please contact Krystyna Oborn/Alice Lawson if you wish to enter.

Richmond: Fan Fund Auction This will be a series of auctions on behalf of various fannish charities — TAFF, GUFF, The Mexican Hat, Fans Across The World. We strongly urge your support. Abigail Frost, Pam Wells, Bridget Wilkinson.

2200 County: **Zagreb in '99 Party** The Zagreb in 99 Worldcon bid presents a "Thank you for Intersection" Party

Windsor: Captain Luddite v Dr Eugene X The Scientist as Baddie. Simon Bradshaw, John Bray, Janet C Johnston.

Monday

	County	Windsor	Richmond	Aintree (Workshop)	Kempton (Workshop)	Costume	Other
1000	Gripe Session				Fantasy Kingdom 3		
1100	21 st Century Odyssey	Auction Overflow	Forgotten Futures				
1200	Drawing Tomorrow						
1300	Tale of a Tale — From Mind to Mind	Fanzines and the Net	Imaginary Countries				
1400	A Very British Genre 5						
1500	Babylon 5 — Space Opera, Soap Opera	Big European Conventions					
1600	Closing Ceremony						
1700	Perfidious Meeja						
1800							
1900							
2000	Drop the Dead Dinosaur Party						

Monday

1000

County: Gripe Session The final opportunity. So! What did you think?

Kempton: Fantasy Kingdom Part 3

1100

County: 21st Century Odyssey SF as travelogue. Maureen Kincaid Speller, Vernor Vinge, Colin Greenland, Mary Gentle.

Richmond: Forgotten Futures Marcus Rowland presents the fourth release of this Victorian Future shareware RPG which includes the original text and illustrations of William Hope Hodgson's "Carnacki" stories plus all the usual game material.

Windsor: Action Overflow The overflow from the other auctions will continue to be auctioned here.

1200

County: Drawing Tomorrow — SF Art Art has always been a very important part of SF, from the earliest pulps to the modern era — comics, line illustrations, covers. What's it like to be an SF artist? Bryan Talbot, SMS, Jim Burns, Fangorn, David Hardy.

1300

County: Tale of a Tale — From Mind to Mind A tale goes through a long and tortuous passage on its journey from author's mind to yours. David G Hartwell, Molly Brown, Ken Slater.

Windsor: Fanzines and the Net What effect is the net having on fanzines? Will electronic distribution ever replace the Gestetner? Pam Wells, Greg Pickersgill, Mike Scott.

Richmond: Imaginary Countries Cherry describes this as her "rude, feminist talk on Imaginary Countries". Cherry Wilder.

1400

County: A Very British Genre, Part 5 — Becoming Invisible This is the last of five panels on the history of British Science Fiction. This series is based on a book written by Paul Kincaid (one of our guests) and published by the British Science Fiction Association this year. Each panel stands alone, but together they'll give an overview of the subject. Kev McVeigh, Maureen Kincaid Speller.

County: Babylon 5 — Soap Opera, Space Opera Is it fair to describe B5 as a cross between a modern Soap Opera and a 1930's Space Opera? Andrew Adams, Kathy Taylor, KIM Campbell, Linda Stratmann.

Windsor: Big European Conventions This is the third of a set of three panels discussing the future of large-scale European conrunning. This one considers the alternatives to a Worldcon every 8-10 years, or a EuSFic Mike Cheater, David Clements, Eckhardt Marwitz, Fiona Anderson.

County: Closing Ceremony The last farewell. Come and say goodbye and thank you to all.

County: Perfidious Meeja Intervention, the 1997 Eastercon Committee present — Radio, TV and the Press have been very cruel to fans on occasion, survivors lick their wounds in public.

County: Drop the Dead Dinosaur Party For the survivors — here comes the meteor! The beer's nearly finished, the tearful goodbyes have been said, the committee have had their nervous breakdowns. Now is the opportunity for a last drink or three together.

1600

1700

2200

Video and Audio Programme

The video and audio programme will be in the **Winchester Suite**, on the top floor of the hotel. It will be a no smoking area, and badges will need to be worn at all times.

Programme times

All times are given over nights:

Date	Core*	Possible Additional**
4 th Thu, 5 th Fri		0000 - 0200
5 th Fri, 6 th Sat	1000 - 0300	0300 - 0400
6 th Sat, 7 th Sun	1000 - 0300	0300 - 0400
7 th Sun, 8 th Mon	1000 - 0300	
8 th Mon, 9 th Tues	1000 - 1600	1600 - 0100***

- * Video and Audio programme definitely runs (but will close for some major mainstream Convention events, check the video programme board!)
- ** Subject to Technical and Hotel availability (see video programme board for details)
- *** Especially subject to Technical and Hotel availability (see video programme board for details)

Full video and audio programme details will be on display outside the room, with the next day's available after 2000. A summary will also be displayed near Registration or near the Con notice board. Video programme items will be coded (the bold abbreviations) to show the topics and if they are dubbed or subtitled.

For the first time (at least for some time) at an Eastercon we are having a small stereo audio programme. Also, in addition to the two main video themes, What If (**W/IF**) and Evolution (**EV**), we also have some anime (**A**), as well as items suitable for younger members (**YSF**), science fact (**S/FACT**) and para-SF (**PSF**). This last category includes interviews with SF people, conventions (especially last year's Glasgow Worldcon Intersection), and SF locations. Some items are sub-titled (**EST**), or are dubbed into English (**E/D**), and foreign language items will be indicated.

All video items are films, in full screen, and colour unless otherwise indicated as television programmes (**TV**), widescreen/letterbox (**L/B**), and black and white (**B+W**).

We will be showing a tape of miscellaneous SF trailers and shorts between scheduled programme items.

You'll find any changes to the video and audio programme in the Con Newsletter.

Dave Lally

- 7 HAMPSHIRE - NEWSROOM
- 8 SANDOWN - ARTSHOW STORE
- 9 ARKLEY - ARTSHOW OFFICE
- 10 AINTREE - WORKSHOP
- 11 CHELTENHAM - FILM DISPLAY
- 12 KEATS - SMALL ROOM
- 13 AUSTIN - SMALL ROOM
- 14 DICKENS - SMALL ROOM
- 15 KIPLING - SMALL ROOM
- 16 KEMPTON - WORKSHOP
- L LIFTS
- T TOILETS

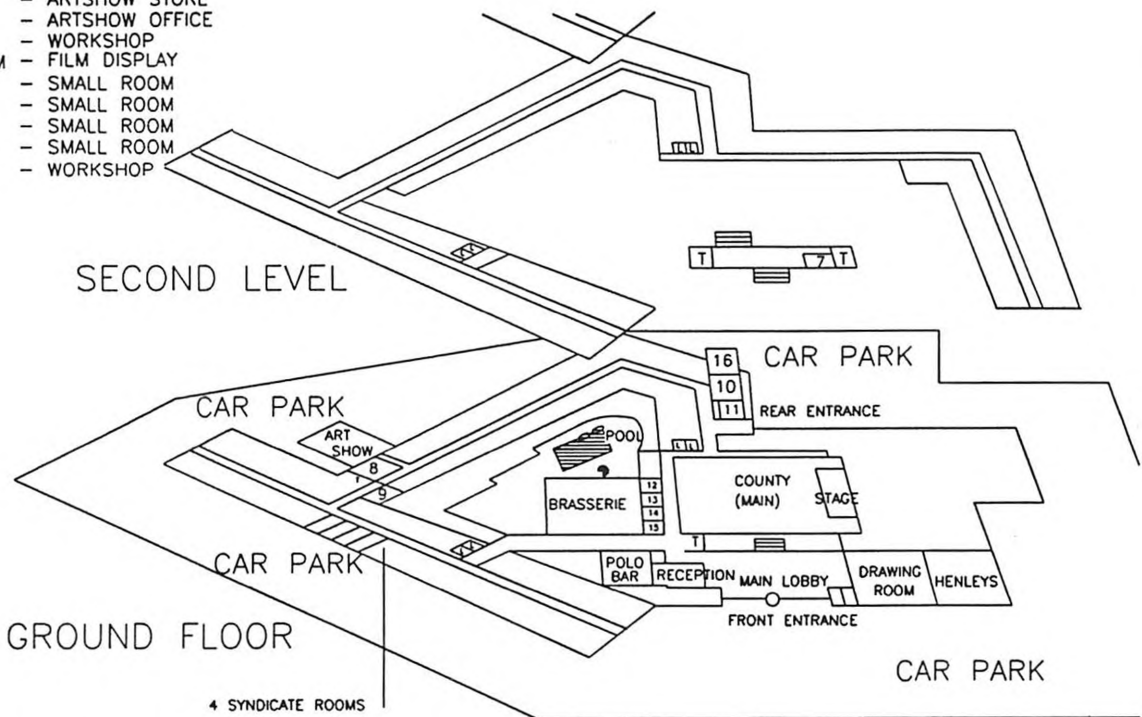

EVOLUTION EASTER 1996

The Radisson Edwardian
Heathrow

- 1 WENTWORTH - COSTUMING
- 2 HAMPSTEAD - GREEN ROOM
- 3 BUCKINGHAM - STORAGE
- 4 WINDSOR - PROGRAMME
- 5 RICHMOND - PROGRAMME
- 6 OPS CENTRE & GOPHER HOLE
- L LIFTS
- T TOILETS

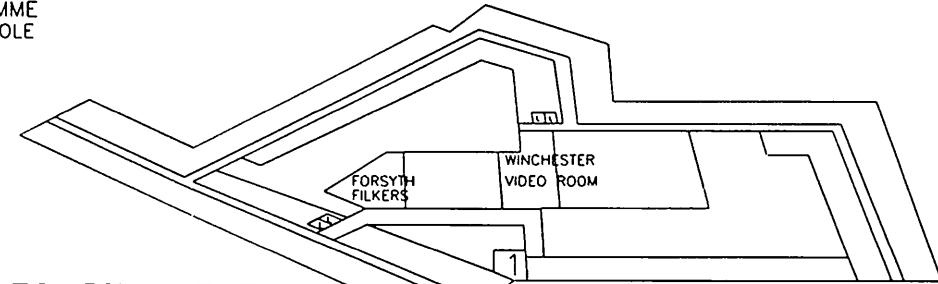

FOURTH LEVEL

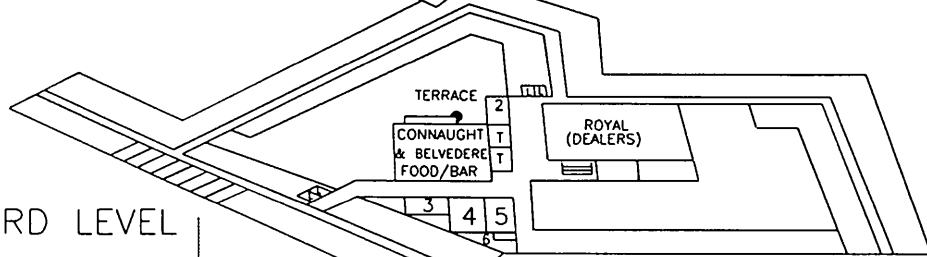

THIRD LEVEL

8 SYNDICATE ROOMS

EVOLUTION EASTER 1996

The Radisson Edwardian
Heathrow

TO HAYES, SHOPS, BANKS
AND RAILWAY STATION

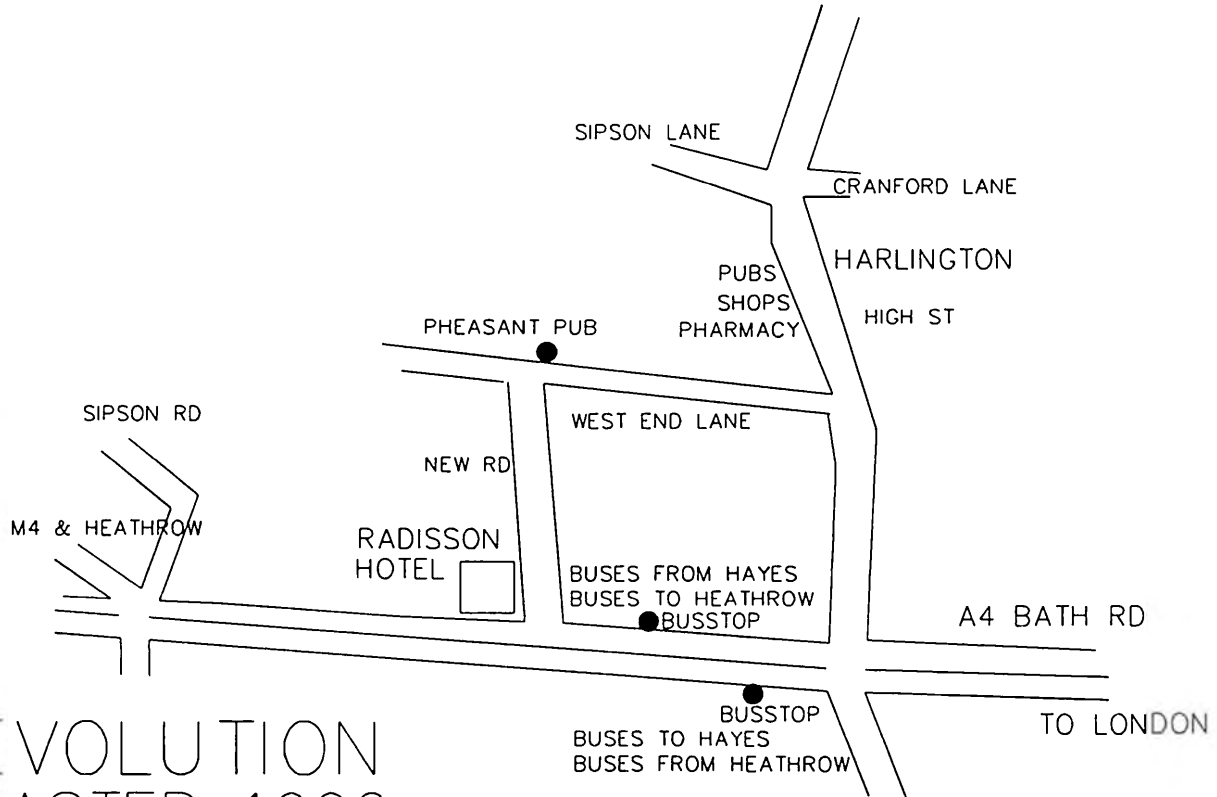

EVOLUTION
EASTER 1996